

**Detached Garage Specifications for:**

Name: \_\_\_\_\_  
Address: \_\_\_\_\_  
\_\_\_\_\_  
Legal Land Location: \_\_\_\_\_  
Phone: \_\_\_\_\_ Fax: \_\_\_\_\_  
Contractor: \_\_\_\_\_ Phone: \_\_\_\_\_

**Specifications**

**Foundation (grade beam & piles) or Slab (Page 3)**  
Slab dimensions: \_\_\_\_\_ wide x \_\_\_\_\_ long  
Slab thickness overall \_\_\_\_\_ perimeter \_\_\_\_\_ (See page 3 for detail)  
Type of base \_\_\_\_\_

**Walls**  
Size & spacing of studs: \_\_\_\_\_  
Size, type & spacing of anchor bolts: \_\_\_\_\_  
Wall/building height to eave: \_\_\_\_\_ Type of siding: \_\_\_\_\_  
Thickness & type of wall sheeting: \_\_\_\_\_  
Insulation & barrier: Yes \_\_\_ No \_\_\_  
Inside finish: \_\_\_\_\_ None \_\_\_\_\_

**\*Size of each vehicle door: Door #1** - Opening width \_\_\_\_\_ & Header size \_\_\_\_\_ ply of 2" x \_\_\_\_\_  
**Door #2** - Opening width \_\_\_\_\_ & Header size \_\_\_\_\_ ply of 2" x \_\_\_\_\_ **Door #3** - Opening width \_\_\_\_\_ & Header size \_\_\_\_\_ ply of 2" x \_\_\_\_\_  
**\*Size of windows/man doors & header:** 1. - Opening width \_\_\_\_\_ & Header size \_\_\_\_\_ ply of 2" x \_\_\_\_\_  
2.- Opening width \_\_\_\_\_ & Header size \_\_\_\_\_ ply of 2" x \_\_\_\_\_ 3. - Opening width \_\_\_\_\_ & Header size \_\_\_\_\_ ply of 2" x \_\_\_\_\_

*\*Note door/window openings on attached sketch, page 2.*

Permit # \_\_\_\_\_  
Town/Village/RM of \_\_\_\_\_  
Date: \_\_\_\_\_

**Wagner Inspection Services**  
Contact Dale  
@  
225-2265 / 241-4741  
wagnerdp@sasktel.net

**Roof**  
Engineered trusses by: \_\_\_\_\_  
Spacing of trusses: \_\_\_\_\_ & overhang: \_\_\_\_\_  
Type of shingles: \_\_\_\_\_  
Ceiling finish: \_\_\_\_\_  
Insulation: \_\_\_\_\_

**Other**  
Heating: \_\_\_\_\_  
Electrical: \_\_\_\_\_  
Pit or Hoist: \_\_\_\_\_  
Recommend eavetroughs and downspouts

- Site Plan (on the reverse side show the following):**
1. Lot dimensions & lot shape
  2. Garage location and set backs from lot lines
  3. All existing buildings, their dimensions & distance to garage.
  4. Location of easements, retaining walls & driveways

# Roof Layout

Indicate the location & \*size of all doors and windows\* and the direction of the roof peak in the drawing below:

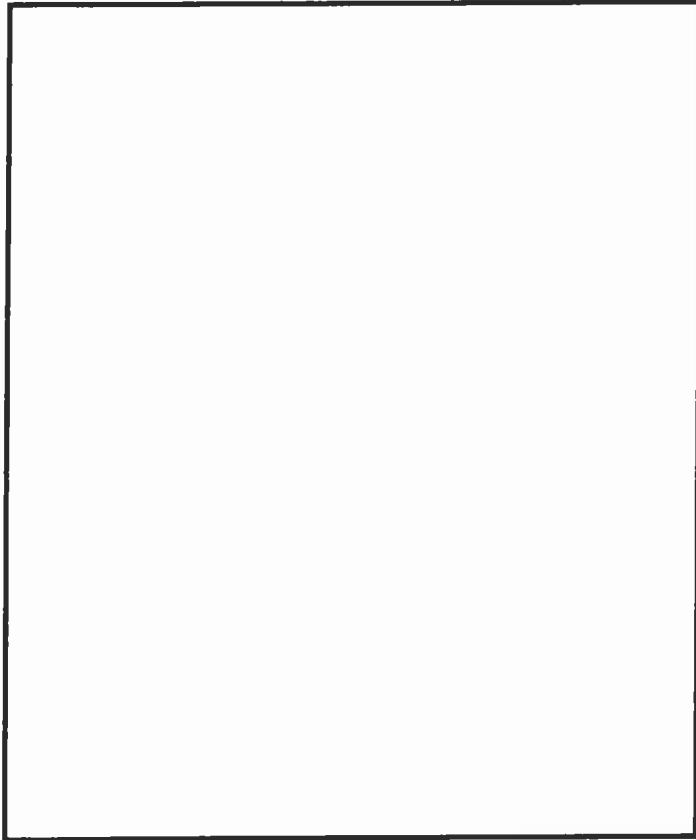

**Wagner Inspection Services**  
 Contact Dale  
 @  
 225-2265 / 241-4741  
 wagnerdp@sasktel.net

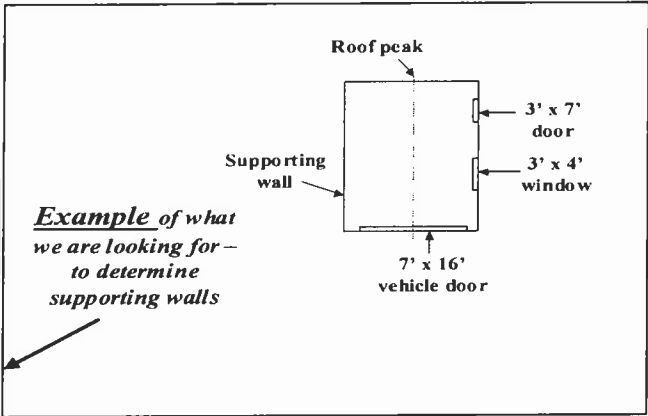

**Note:** venting & attic hatch required if insulating

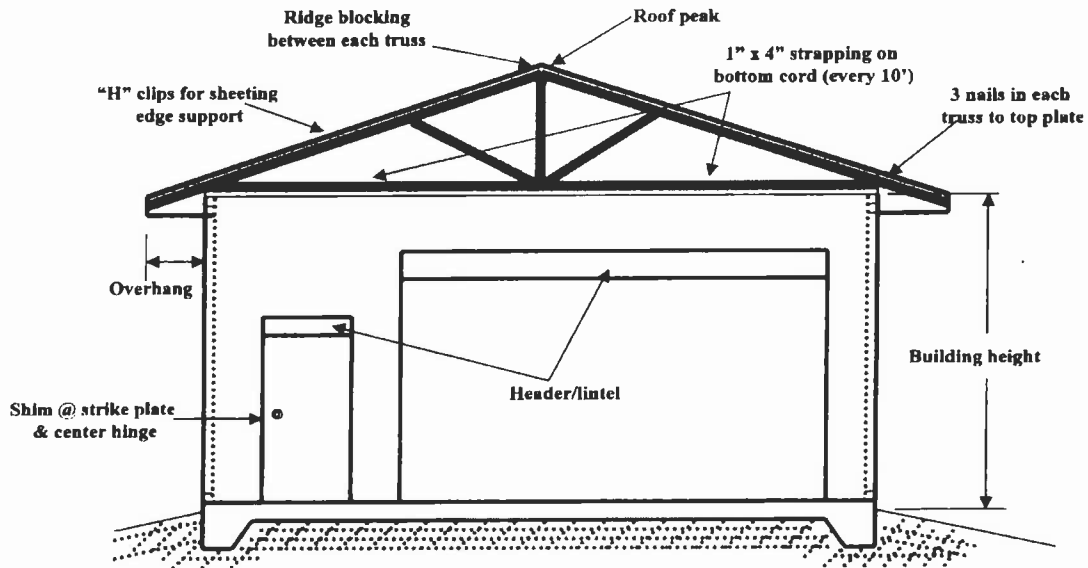

## Recommended Reinforced Thickened Edge Concrete Slab

Wagner Inspection  
 Services  
 Contact Dale  
 @  
 225-2265 / 241-4741  
 wagnerdp@sasktel.net

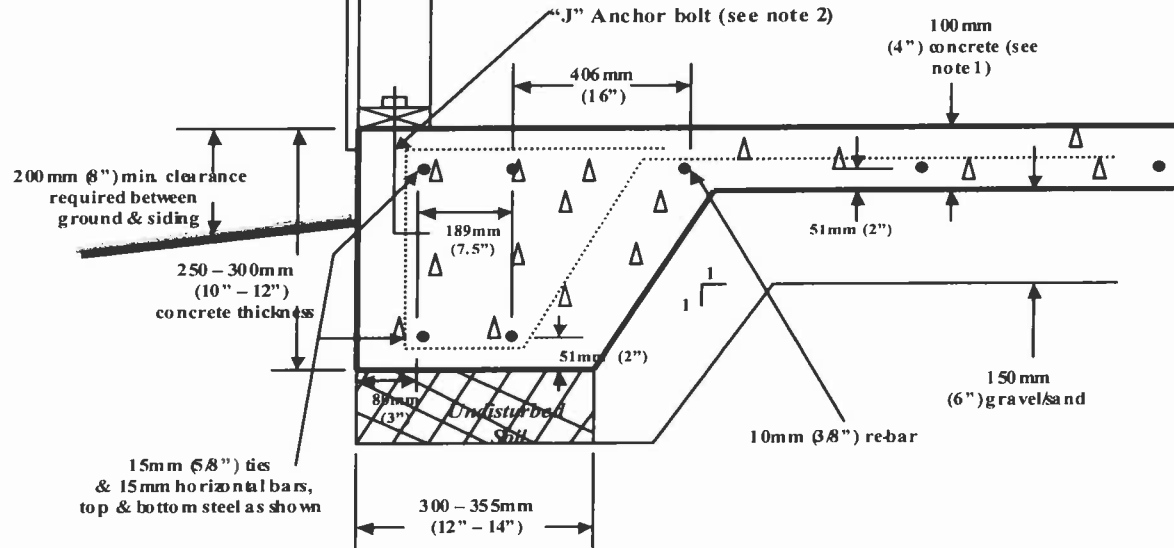

### Notes:

1. 102mm (4") thick reinforced concrete slab with 10mm (3/8") dia re-bar at 406mm (16") on center each placed on:
  - 1a. 6 mil poly cover and (as per CGS B51.34M)
  - 1b. 152mm (6") deep compacted gravel base.
2. Around the perimeter place 12.7., (1/2") x 203mm (5") anchor bolts or equivalent at 900mm to 1200mm (36" to 48") spacing